

## Multi-function Display (MFD)

INSTRUMENTATION/DRIVER INFO

### 10. Multi-function Display (MFD)

#### A: REMOVAL

##### 1. MULTI FUNCTION DISPLAY

1) Disconnect the ground cable from battery. <Ref. to NT-5, BATTERY, NOTE, Note.>

NOTE:

For models other than STI model, disconnect the ground terminal from battery sensor.

2) Remove the panel center assembly. <Ref. to EI-66, REMOVAL, Center Console.>

3) Release the claw and hook, and then remove the cover center UPR.

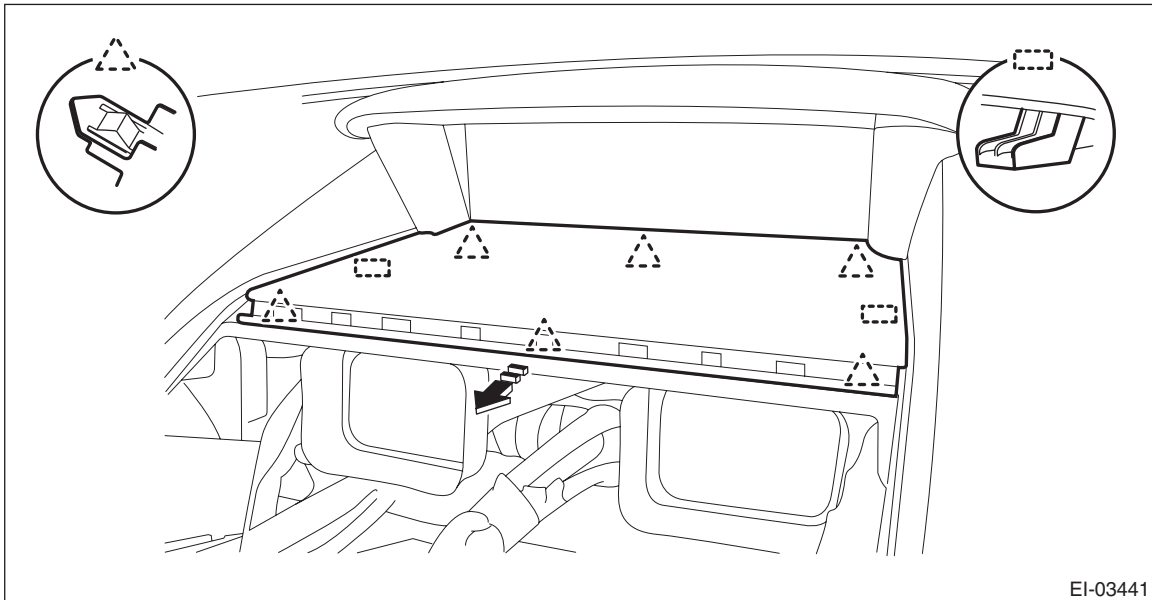

NOTE:

Lightly push up the back of the cover center UPR, hook the finger to the end portion and pull it toward you to remove it.

4) Remove the multi-function display.

**CAUTION:**

**Be careful not to damage the multi-function display or instrument panel.**

(1) Release the screws and claws.

(2) Pull the multi-function display assembly toward yourself, and disconnect the connector.

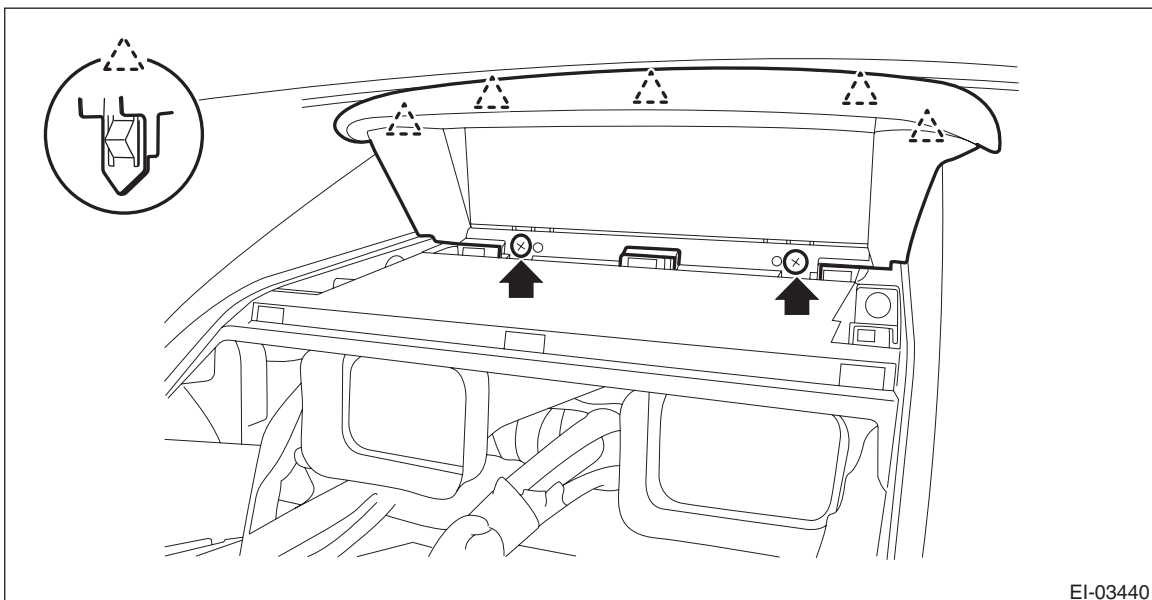

- (3) Remove the screws and then remove the multi-function display.

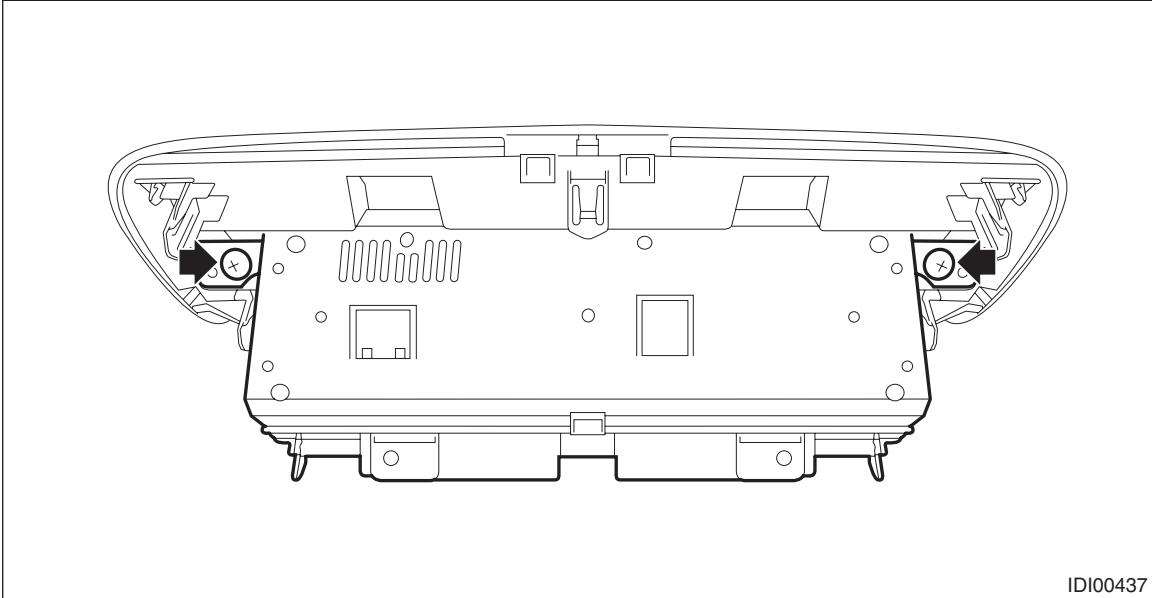

## 2. MULTI-FUNCTION DISPLAY SWITCH

- 1) Disconnect the ground cable from battery. <Ref. to NT-5, BATTERY, NOTE, Note.>

### NOTE:

For models other than STI model, disconnect the ground terminal from battery sensor.

- 2) Pull out the panel center assembly. <Ref. to EI-66, REMOVAL, Center Console.>

- 3) Remove the switch - multi-function display.

- (1) Reach through the clearance (a) between the instrument panel assembly and the panel center assembly, release the claws, and push out the switch - multi-function display.  
(2) Disconnect the connector and remove the switch - multi-function display.

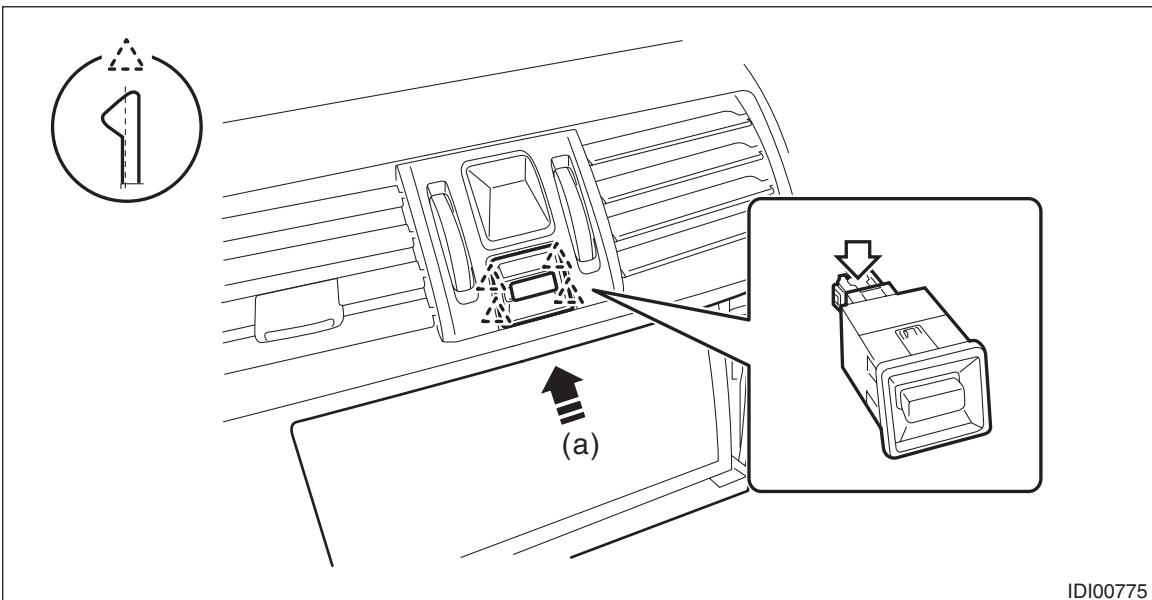

## B: INSTALLATION

### 1. MULTI FUNCTION DISPLAY

**CAUTION:**

- Make sure the electrical connector is connected securely.
- Make sure that the multi-function display operates normally.
- After installing the panel center assembly, check that the air vent grille of the panel center assembly is inserted correctly into the air vent duct.
- When the multi-function display has been replaced, perform the following operations.
  - Be sure to reset the ODO fuel economy value of the multi-function display (MFD). <Ref. to IDI-12, ODO FUEL ECONOMY VALUE RESET, OPERATION, Multi-function Display (MFD) System.>
  - Be sure to correction the lifetime fuel economy value of the multi-function display (MFD). <Ref. to IDI-10, DIAGNOSTIC MODE, OPERATION, Multi-function Display (MFD) System.>

- 1) Install the multi-function display.
- 2) Install the cover center UPR.
- 3) Install the panel center assembly.
- 4) Connect the battery ground terminal. <Ref. to NT-5, BATTERY, NOTE, Note.>

**NOTE:**

For models other than STI model, connect the ground terminal to battery sensor.

### 2. MULTI-FUNCTION DISPLAY SWITCH

**CAUTION:**

**After installing the panel center assembly, check that the air vent grille of the panel center assembly is inserted correctly into the air vent duct.**

- 1) Install the switch - multi-function display.
- 2) Install the panel center assembly.
- 3) Connect the battery ground terminal. <Ref. to NT-5, BATTERY, NOTE, Note.>

**NOTE:**

For models other than STI model, connect the ground terminal to battery sensor.

C: INSPECTION

1. MULTI-FUNCTION DISPLAY SWITCH

1) Measure the resistance between connector terminals.

Preparation tool:  
Circuit tester

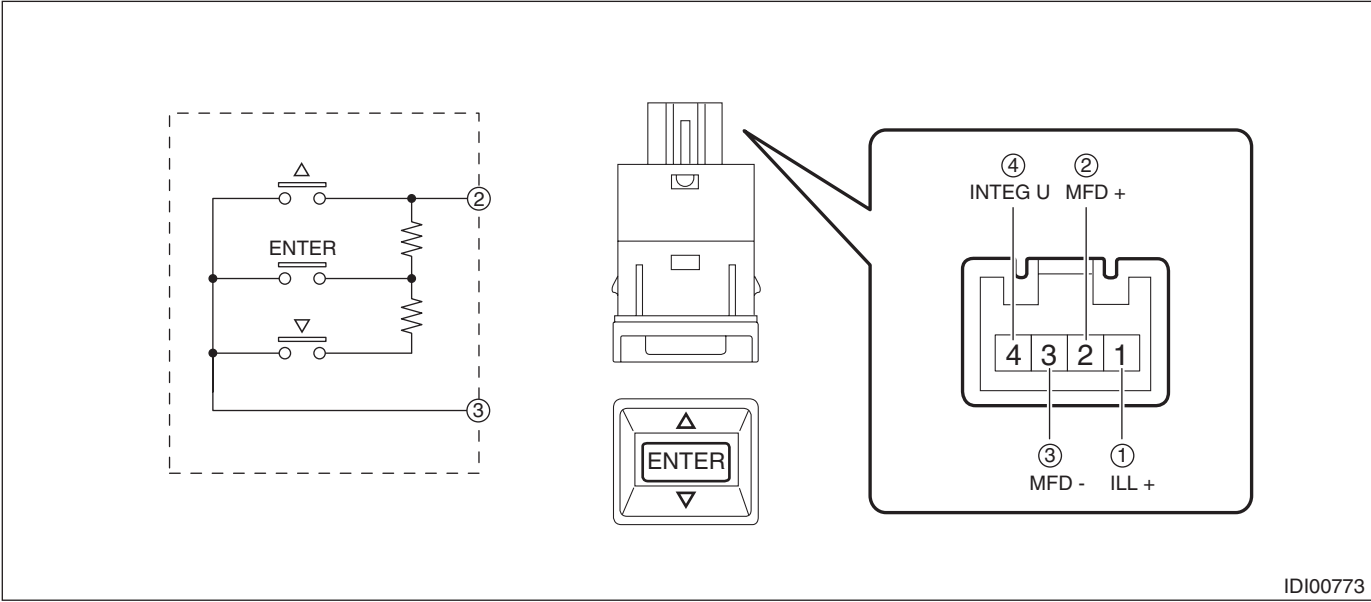

IDI00773

Terminal No.	Inspection conditions		Standard
2 — 3	△ (UP) ENTER ▽ (DOWN)	All OFF	Approx. 1 MΩ or more
2 — 3	△ (UP)	ON	Less than 1 Ω
2 — 3	ENTER	ON	Approx. 1000 Ω
2 — 3	▽ (DOWN)	ON	Approx. 3670 Ω

2) If the inspection result is not within the standard, replace the switch - multi-function display.